

## EU Declaration of Conformity (DOC)

|                    |                             |
|--------------------|-----------------------------|
| Company name:      | Mid Ocean (Brands) BV (MOB) |
| Postal address:    | PO BOX 644                  |
| Postcode and City: | 6710 BP Ede (NL)            |
| Telephone number:  | 0031 (0)342 426992          |
| E-mail address:    | DOC@reclamond.com           |

**We declare that DOC issued under our sole responsibility and belongs to the following product:**

|                    |   |
|--------------------|---|
| Item number:       | MO9544  |
| Description:       | Children colouring set with 30 colouring recycled paper sheets. Includes 6 colouring pencils, sharpener and eraser. |
| Classification:    | Toys intended for children above 36 months  |
| Country of Origin: | China   |
| Batch:             | PO 41-115786  |

**Object of the declaration** (identification of apparatus allowing traceability; it may include a colour image of sufficient clarity where necessary for the identification of the apparatus):

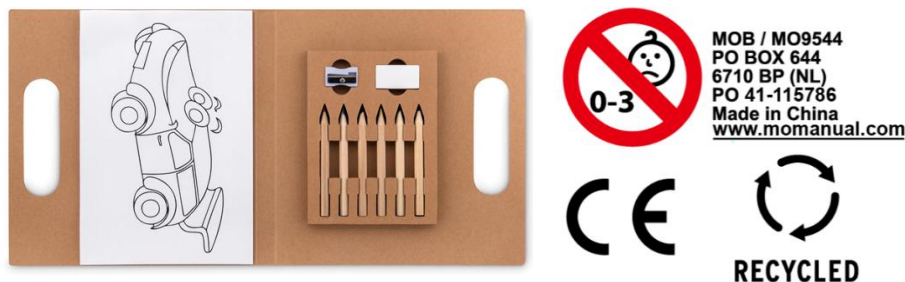

**The object of the declaration described above is in conformity with the relevant Union harmonization legislation: Toys Directive 2009/48/EC**

*Toys Directive 2009/48/EC*  
*General Product Safety Regulation (EU) 2023/988*  
*REACH Regulation 1907/2006/EC*

**The following harmonized standards and technical specifications have been applied:**

Title, date of standard/specification:  
*Toys: EN 71-1:2014+A1:2018, EN 71-2:2020, EN 71-3:2019+A1:2021*  
*REACH: Cd, 7P, PAHs, Benzene, PCP, Formaldehyde*

|                                   |                               |
|-----------------------------------|-------------------------------|
| Notified body (where applicable): | 4 digit notified body number: |
|                                   |                               |

**Additional information:**

**Signed for and on behalf of:**

|          |            |
|----------|------------|
| Ede (NL) | 01-01-2025 |
|----------|------------|

|                |               |
|----------------|---------------|
| Place of issue | Date of issue |
|----------------|---------------|

  
**R.M. Sillessen**  
General Manager  
solo midocean